



wahsega

Panic/Call Button

Installer's Guide



Getting Started

This step-by-step guide will help you install your Wahsega Speaker Panic/Call Button.

What You Will Need

- **Wahsega speaker**

- Compatible models:

WL-SPKR-ALT-SIP
WL-SPKR-22-CAR
WL-SPKR-22-INF
WL-SPKR-22-CAR-2CH
WL-SPKR-22-INF-2CH
WL-SPKR-22-2R
WL-SPKR-SMT-CAR
WL-SPKR-SMT-INF
WL-SPKR-SMT-CAR-2CH
WL-SPKR-SMT-INF-2CH
WL-SPKR-SMT-2R
WL-IPD-SPKR-510-CAR
WL-IPD-SPKR-510-INF

WL-IPD-SPKR-520-CAR
WL-IPD-SPKR-520-INF
WL-IPD-SPKR-510D-CAR
WL-IPD-SPKR-510D-INF
WL-IPD-SPKR-510D-CAR-TM
WL-IPD-SPKR-510D-INF-TM
WL-IPD-SPKR-540-CAR
WL-IPD-SPKR-540-INF
WL-ZN-CTR-1CH-CAR-R
WL-ZN-CTR-1CH-INF-R
WL-ZN-CTR-2CH-CAR
WL-ZN-CTR-2CH-INF

- **2-wire low voltage cable** (18-22 AWG recommended)
- **Small flat head screwdriver**
- **Phillips head screwdriver**

Connecting Your Panic/Call Button

1. At speaker, connect a one 18-22 AWG wire to Input 1. Connect second 18-22 AWG wire to 12 V RTN (GND).
2. At the call button, connect one wire to each terminal on the back of the button. Connections are not polarized, so it does not matter which wire is connected to which terminal.

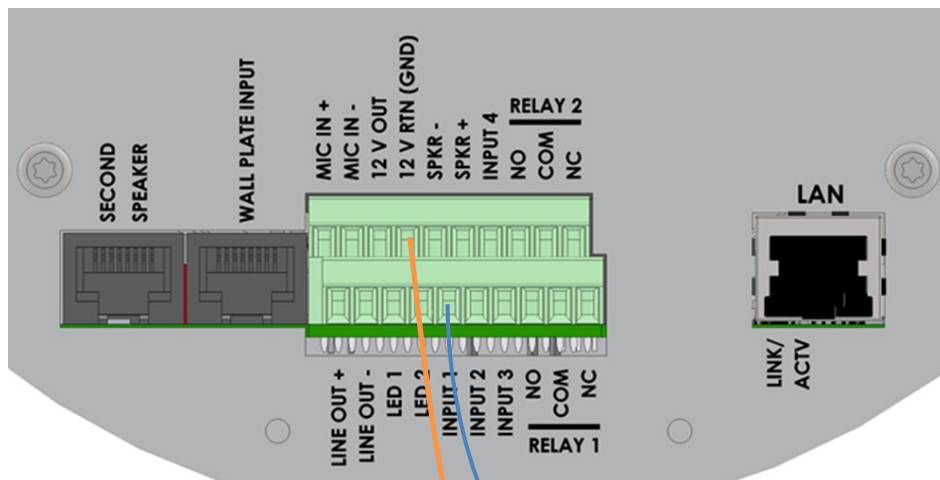
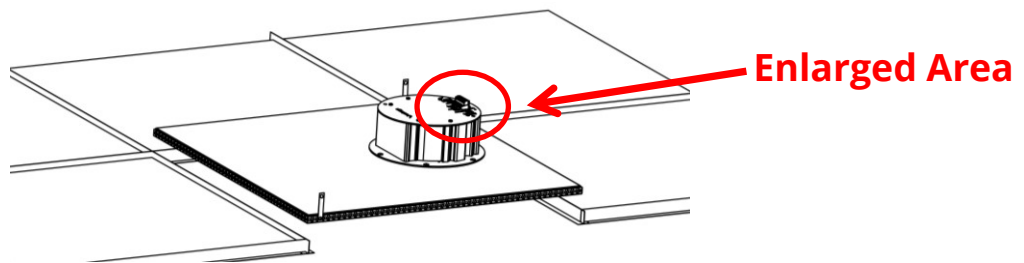

At speaker, connect  18-22 AWG wire to **Input 1** and **12V Return**.

At call button, connect one wire to each of the two terminals.

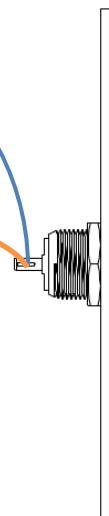

3. Fasten the Call Button's faceplate to a single-gang backbox using the included screws.

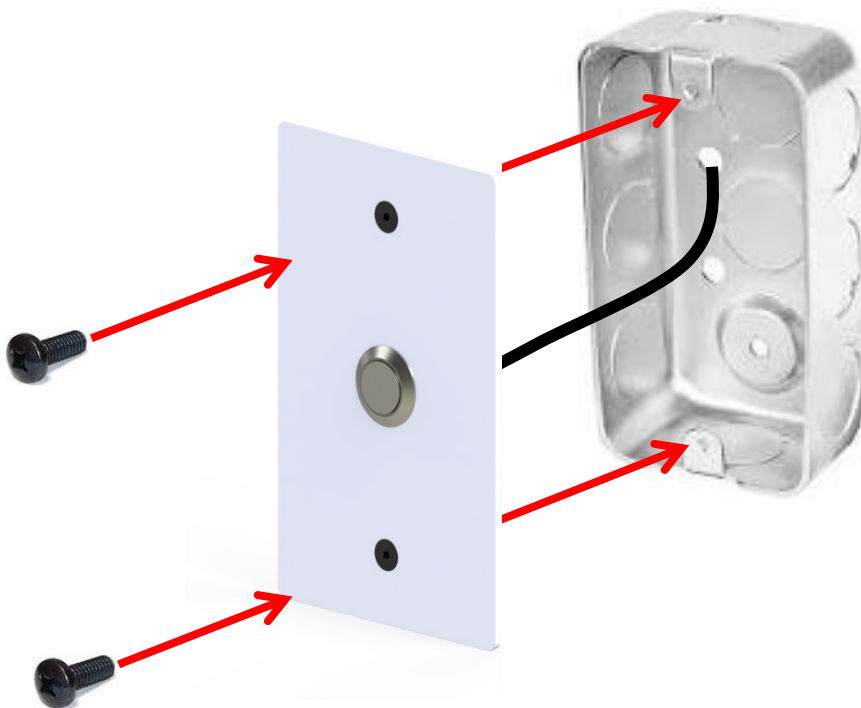

Dimensions

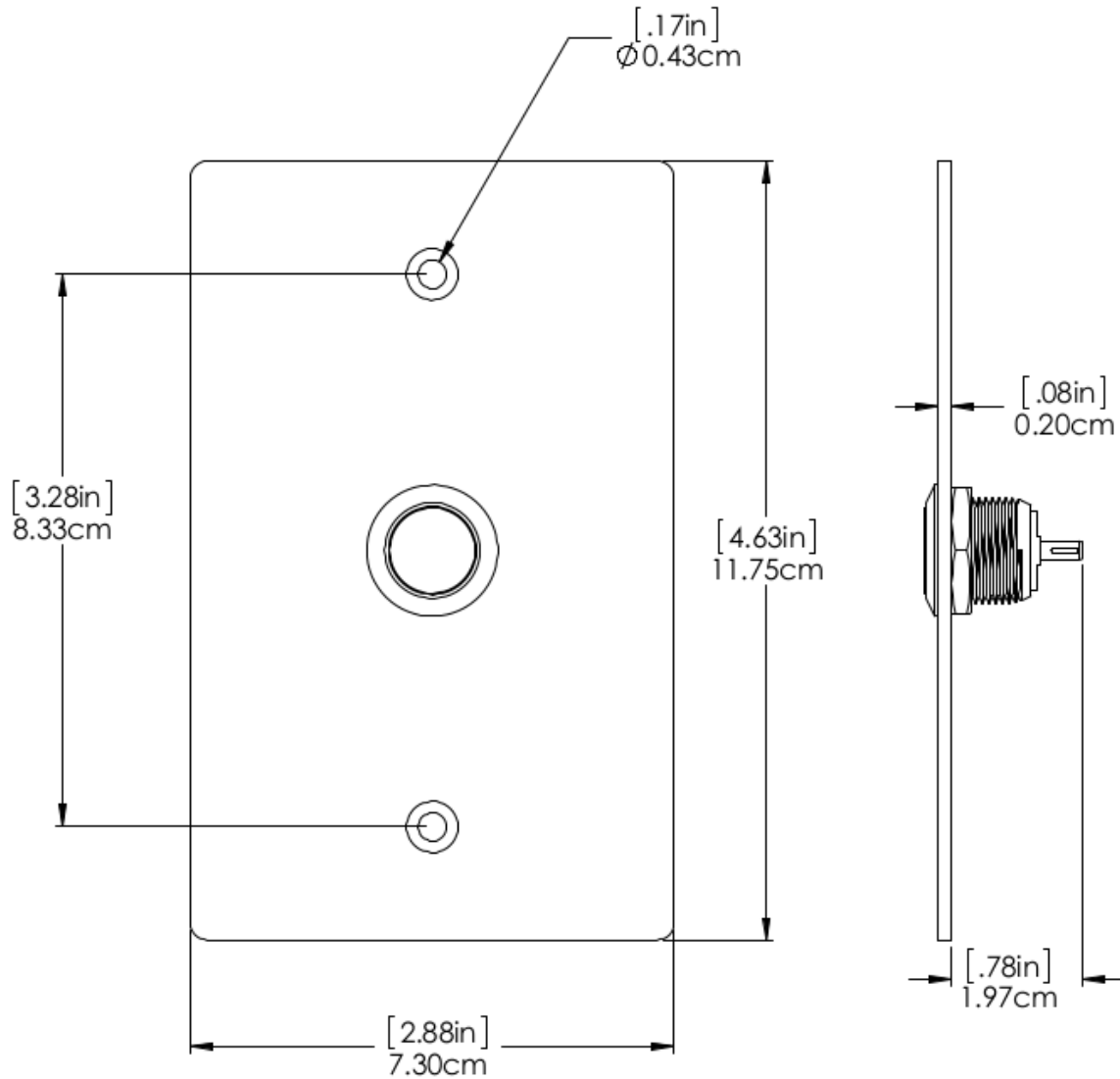

Standards Compliant

This product is designed and manufactured in the USA.

- ROHS compliant
- Temperature rating -40C to +60C.



Wahsega Panic/Call Button

WL-SPKR-RB-W

Installation Guide