



wahsega

Wall Mount Extension Speaker

Installer's Guide



Getting Started

This step-by-step guide will help you install your Wahsega Wall Mount Extension Speaker.

What's In the Box

- **Speaker assembly**
- **Mounting bracket**
- **Mounting hardware**
 - (4) #6-32 Screws
 - (4) #6 lock washers
 - (8) #8-32 Screws
 - (8) #8 lock washers

What You Will Need

- **Wahsega primary speaker**

- Compatible models:

WL-SPKR-22-CAR

WL-SPKR-22-INF

WL-SPKR-22-CAR-2CH

WL-SPKR-22-INF-2CH

WL-SPKR-SMT-CAR

WL-SPKR-SMT-INF

WL-SPKR-SMT-CAR-2CH

WL-SPKR-SMT-INF-2CH

WL-IPD-SPKR-510-CAR

WL-IPD-SPKR-510-INF

WL-IPD-SPKR-510-CAR-2CH

WL-IPD-SPKR-510-INF-2CH

WL-IPD-SPKR-520-CAR

WL-IPD-SPKR-520-INF

WL-IPD-SPKR-510D-CAR

WL-IPD-SPKR-510D-INF

WL-IPD-SPKR-510D-CAR-TM

WL-IPD-SPKR-510D-INF-TM

WL-IPD-SPKR-540-CAR

WL-IPD-SPKR-540-INF

- **Network cable**

- Cat 5e or Cat 6 straight cable

- **Screwdrivers**

- Small flat head screwdriver
 - Phillips head screwdriver

Connecting Your Wahsega Extension Speaker

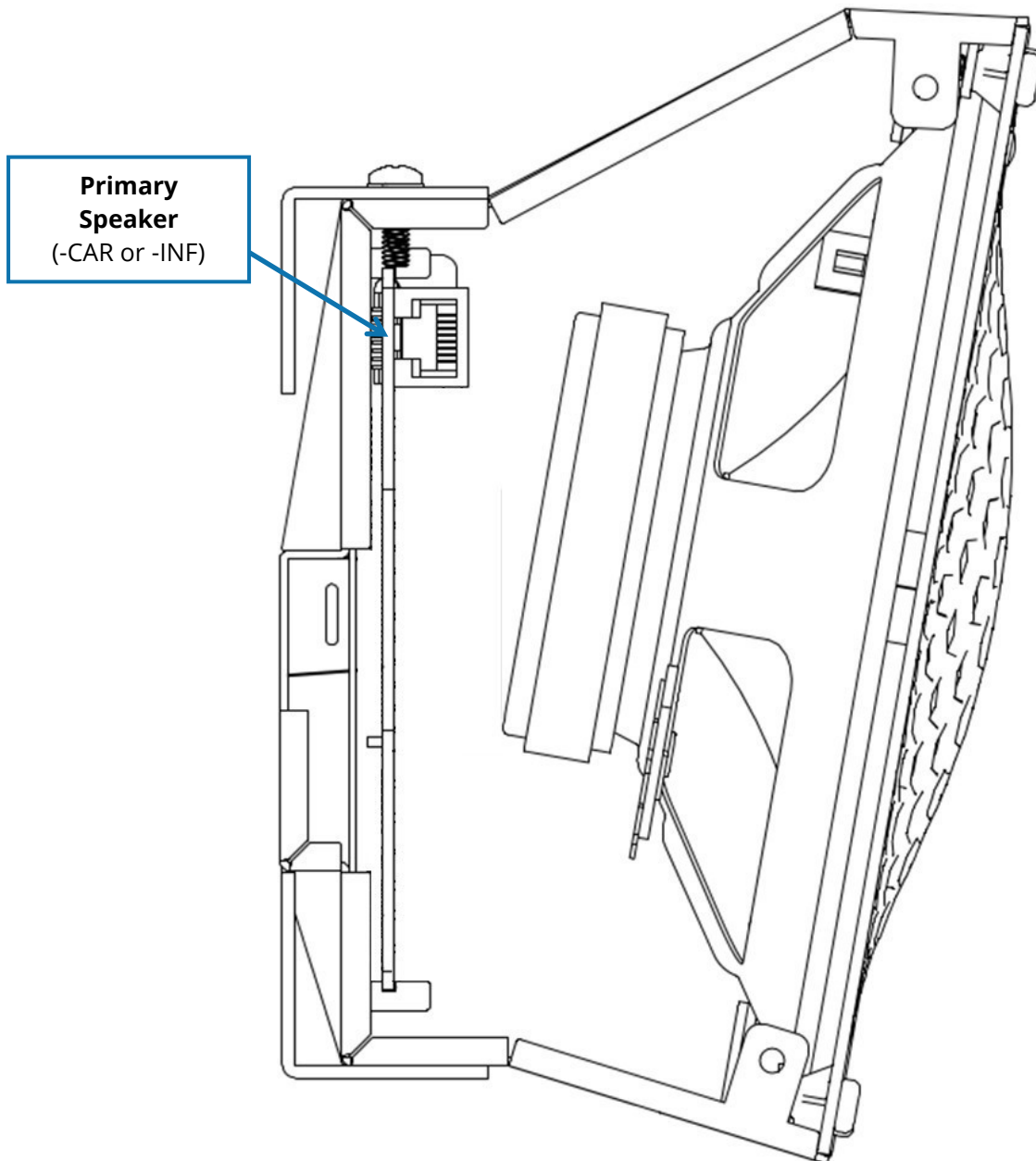

PRIMARY SPEAKER CONNECTION

The -A speaker receives its power and data from a Wahsega primary speaker. Connect a Cat5e or Cat6 straight cable to the primary speaker up to 20m away. Do not use a crossover cable.

- Compatible models:

WL-SPKR-22-CAR	WL-IPD-SPKR-510-CAR
WL-SPKR-22-INF	WL-IPD-SPKR-510-INF
WL-SPKR-22-CAR-2CH	WL-IPD-SPKR-510-CAR-2CH
WL-SPKR-22-INF-2CH	WL-IPD-SPKR-510-INF-2CH
WL-SPKR-SMT-CAR	WL-IPD-SPKR-520-CAR
WL-SPKR-SMT-INF	WL-IPD-SPKR-520-INF
WL-SPKR-SMT-CAR-2CH	WL-IPD-SPKR-510D-CAR
WL-SPKR-SMT-INF-2CH	WL-IPD-SPKR-510D-INF
	WL-IPD-SPKR-510D-CAR-TM
	WL-IPD-SPKR-510D-INF-TM
	WL-IPD-SPKR-540-CAR
	WL-IPD-SPKR-540-INF

- Once the unit is successfully powered, the amber indicator LED on the front of the speaker will begin to blink.

Mounting and Installation

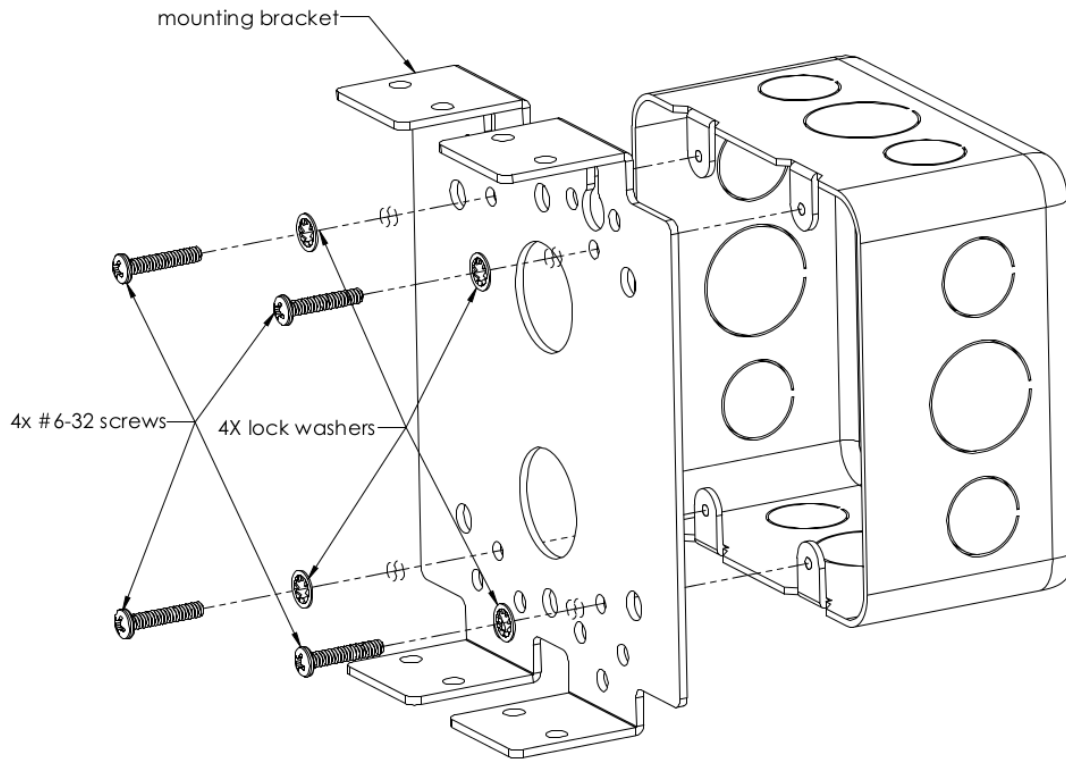

Mount included bracket to the front of a standard two-gang electrical backbox (preferred), using (4) included #6-32 screws and lock washers.

If mounting bracket to a solid surface rather than to an electrical backbox, use the appropriate bolts and anchors for that surface.

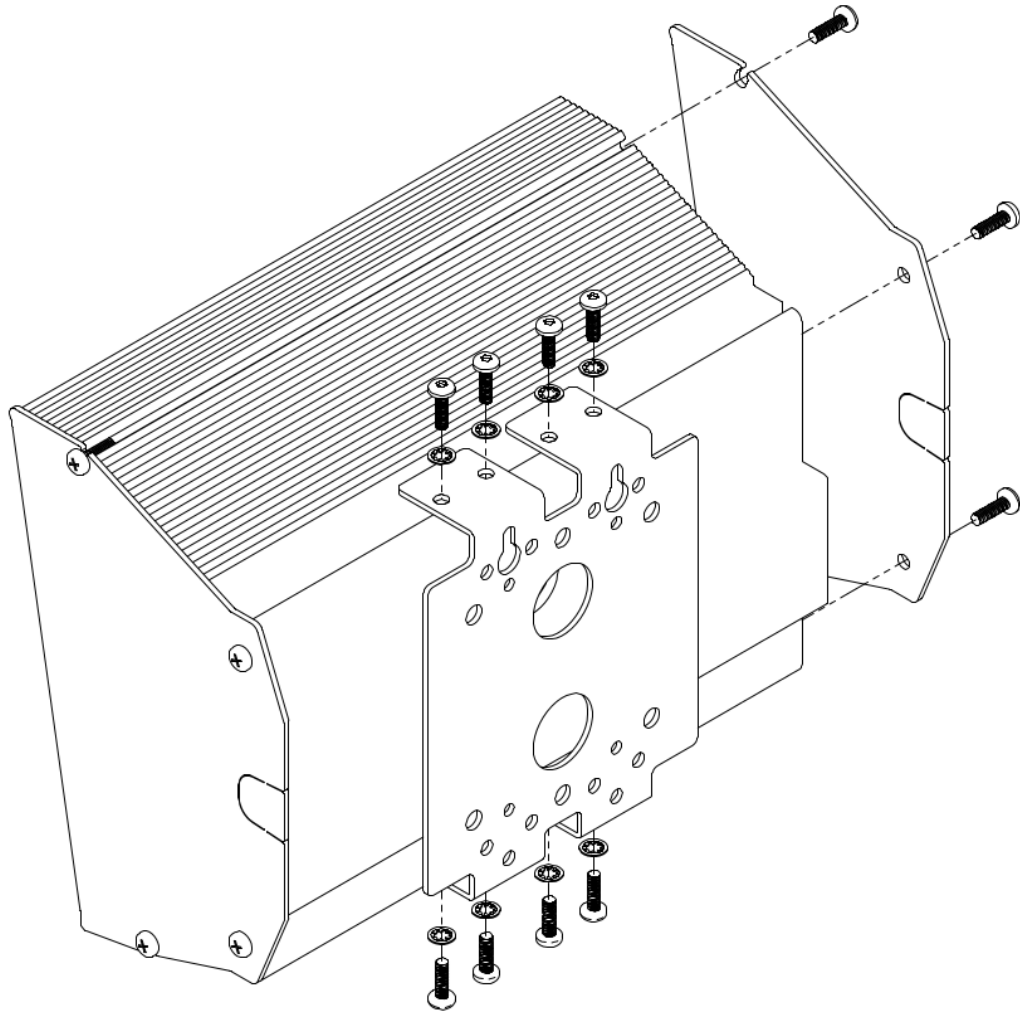

Attach speaker to bracket using included (8) #8-32 screws and washers.

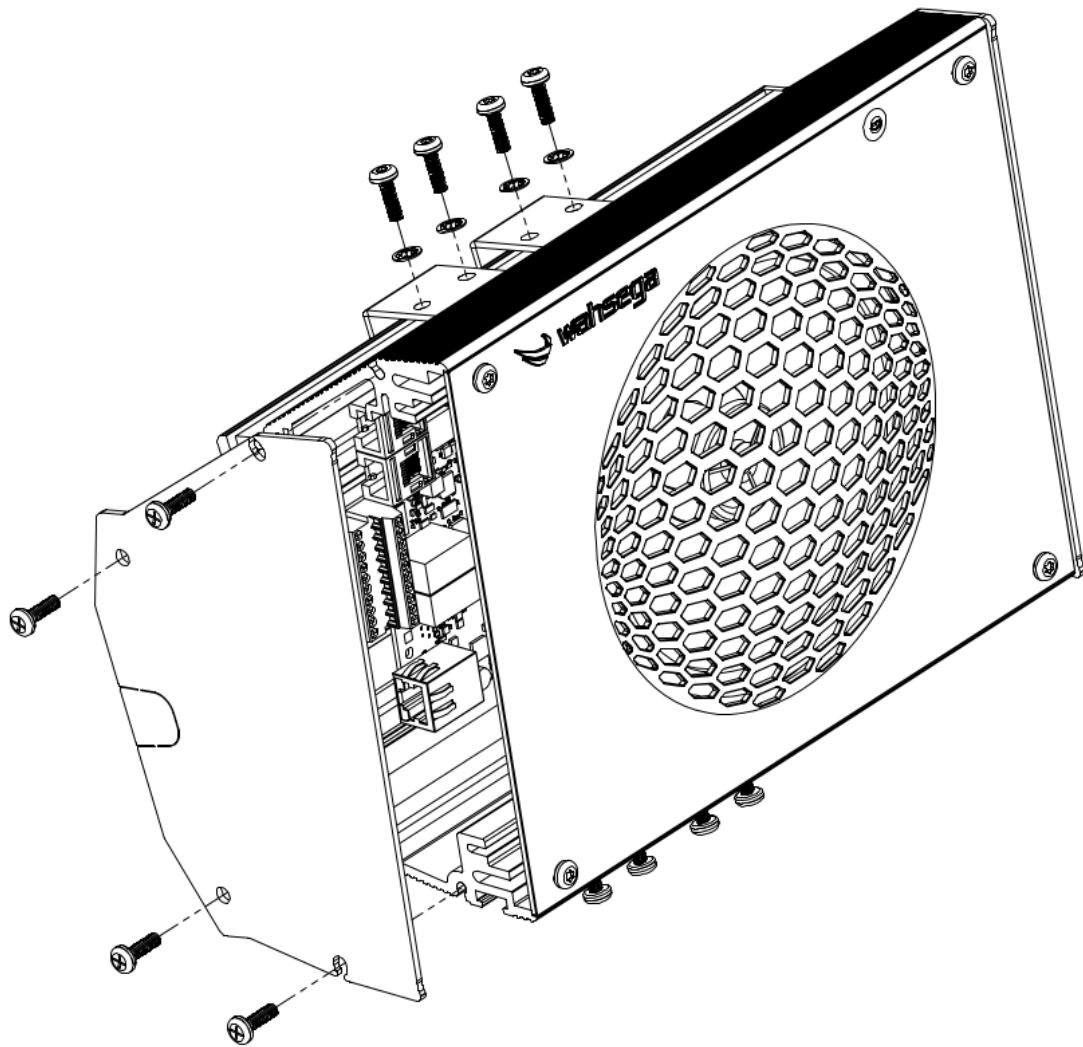

Cable access is available through rear opening or side panel knockout.

Dimensions

Front

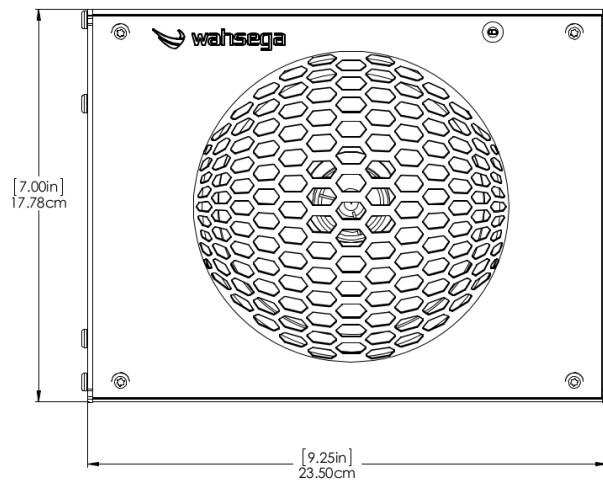

Side

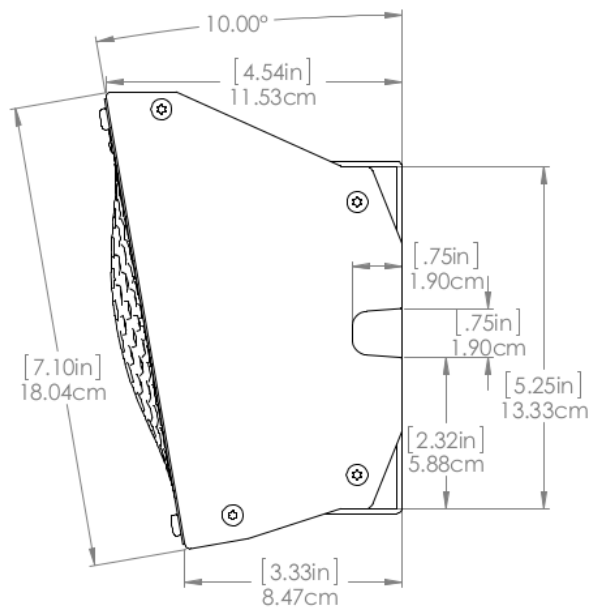

Rear

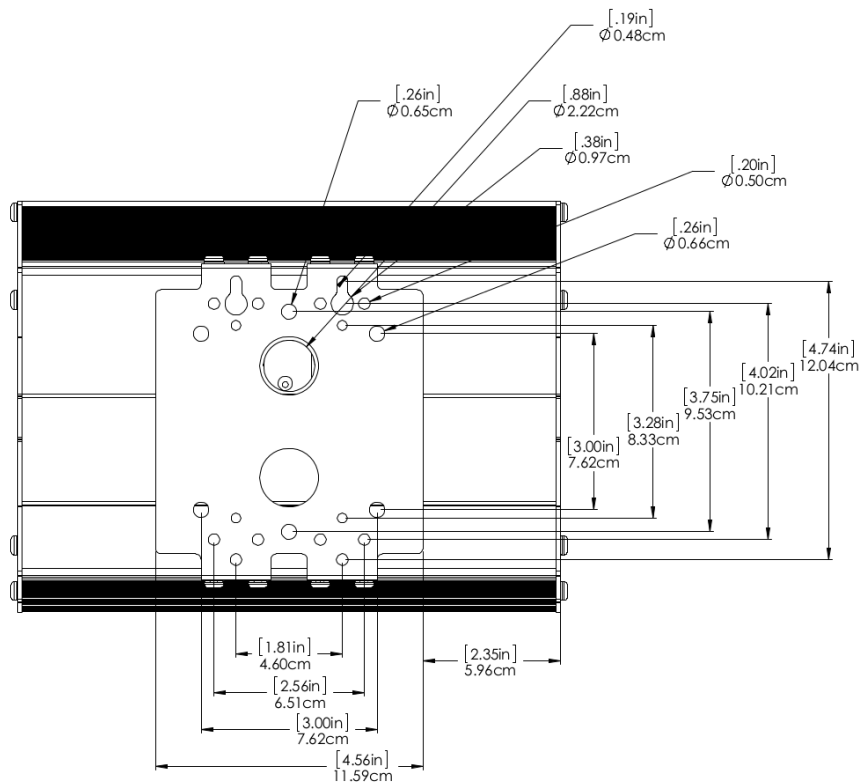

Standards Compliant

This product is designed and manufactured in the USA.

- ROHS compliant
- Temperature rating -40C to +60C.



Wahsega Wall Mount Extension Speaker

WL-SPKR-SMT-A

Installation Guide