

Carina Extra Large IP Display

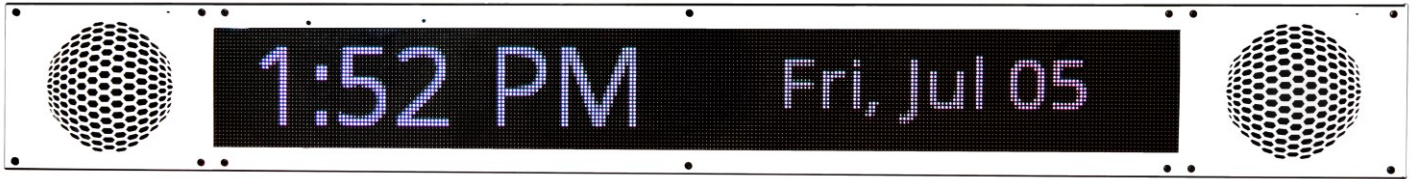

Description

Wahsega's Carina line of PoE-enabled IP Displays are automatically discovered by the Carina Event Manager at initialization, and central configuration and global programming options in the Event Manager assure quick system setup.

The Carina Extra Large IP Display displays continuous time and date and also allows critical textual information from Event Manager alerts to be scrolled on the display. The Carina Extra Large IP Display has a 40-inch wide LED display which supports over 32,000 colors with an LED resolution that is twice what competing products provide. All text is rendered using vector fonts, allowing for improved readability.

The Carina Extra Large IP Display supports SIP registration for calls as well as multicast for bells, pages or background music from the Event Manager. With network connectivity, scrolling LED display, built-in speaker and multi-color flashers, the Carina Extra Large IP Display broadcasts both audible and visible Event Manager messages to hallways, classrooms, offices and large rooms.

Two integrated relays let building managers remotely control external devices, which can be activated via SIP call or Event Manager broadcast. A built-in microphone allows for two-way SIP communication, and time synchronization is handled by the Event Manager's SNTP Server.

The Carina Extra Large IP Display can even power a second, extension speaker (WL-SPKR-xx-A) up to 20 meters away via an Ethernet cable, increasing the audio coverage in the space. One Cat5e or Cat6 homerun provides power and data for both speakers.

Features



Job Name:	<input type="text"/>	Model Numbers:	<input type="text"/>	Date:	<input type="text"/>
Location:	<input type="text"/>	Notes:	<input type="text"/>		

- Dual registration: SIP and Carina
- Auto-discovery on Wahsega Carina Event Manager
- PoE 802.3af enabled
- Able to drive second Wahsega analog speaker $\leq 20\text{m}$ away via Cat5e or Cat6
- Fully configurable via Carina Event Manager
- Multiple audio codecs to choose from
- Simple surface-mount wall installation
- Built-in microphone for two-way communication
- Web-based mic and speaker volume control
- Classroom sound reinforcement audio input wallplate available
- Status feedback
- Two onboard relays for door control
- Text display up to 5" high
- RJ45 connections for simplified installation of second speaker and remote sound reinforcement wallplate
- Compatible with standard panic buttons
- Advanced panic button functionality to reduce false alarm triggers
- One to three lines of text display
- Time set by Event Manager SNTP Server with no manual adjustments necessary
- Receive bell and event schedule alerts from Event Manager via RTP Multicast
- Display 12- or 24-hour clock with four or six numerals
- Two multicolor and one white flasher
- Auto-dim feature for energy reduction
- Text display is configurable for scrolling of page by page mode.
- 32,768 LED colors
- 32 x 64 resolution

Specifications

- Ethernet: 10/100 Mbps
- Power Input: PoE 802.3af
- Standby power: <2 Watts
- Protocol: SIP RFC 3261 compatible
- Audio Codecs: 16-bit PCM (uncompressed), u-law (G.711u), a-law (G.711a), G.722, G.729
- Audio Sampling: 8 kHz, 16 kHz, or 32 kHz
- Speaker Drive Capabilities: 8W (5W per speaker when driving two speakers)
- Speaker Impedance: 8Ω
- Speaker Sensitivity: 96dB 1W/0.5M SPL
- Coverage Angle: 120° / 4 kHz
- Dry Contact Relay Rating: 2A min, 250V AC, 24V DC
- Max PoE Cable Length: 100m (per standard) PoE 10/100 cable length
- Max Secondary Speaker Cat5e or Cat6 Cable Length: 20m
- Temperature Range: -40°C to $+60^\circ\text{C}$
- Weight: 24.5 lbs
- Overall Dimensions: 58.64" W x 7.00" H x 4.54" D
- LED Panel Dimensions: 5" tall x 40" wide
- Construction: Metal housing with polyester powdercoat paint
- Warranty: 2 years limited

Job Name: **Model Numbers:** **Date:**

Location: **Notes:**

Model Numbers

WL-IPD-SPKR-540-CAR

Wahsega Labs	Display	Speaker	Display Height	Display Width	Protocol
WL	IPD	SPKR	5	40	CAR
Wahsega Labs	IP Display	with Speaker	5 = 5" High Display	10 = 10" Wide Display 20 = 20" Wide Display 40 = 40" Wide Display D = Double Sided (10" only)	CAR = Carina INF = InformaCast

Installation

Simple, surface mount wall installation with rear and side access for wiring. Power supplied via Power over Ethernet (PoE) 802.3af. The Wahsega Extra Large IP Display mounts to the front of four (4) single-gang or two-gang electrical backboxes or to the surface of a wall, using its included mounting brackets and the appropriate wall anchors for the mounting surface.

Job Name: **Model Numbers:** **Date:**

Location: **Notes:**

Dimensions

Front View

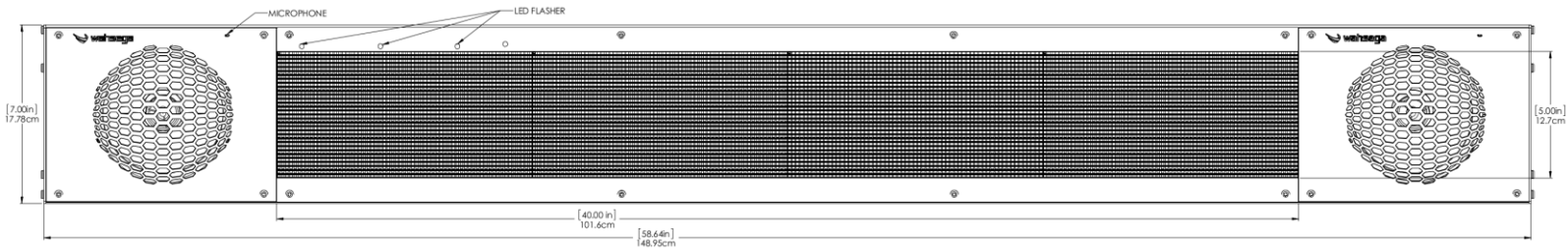

Rear View

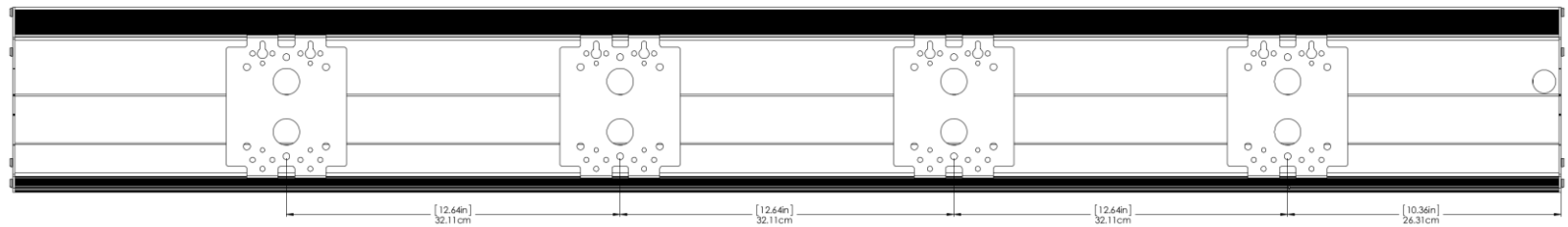

Job Name: Model Numbers: Date:

Location: Notes:

Side View

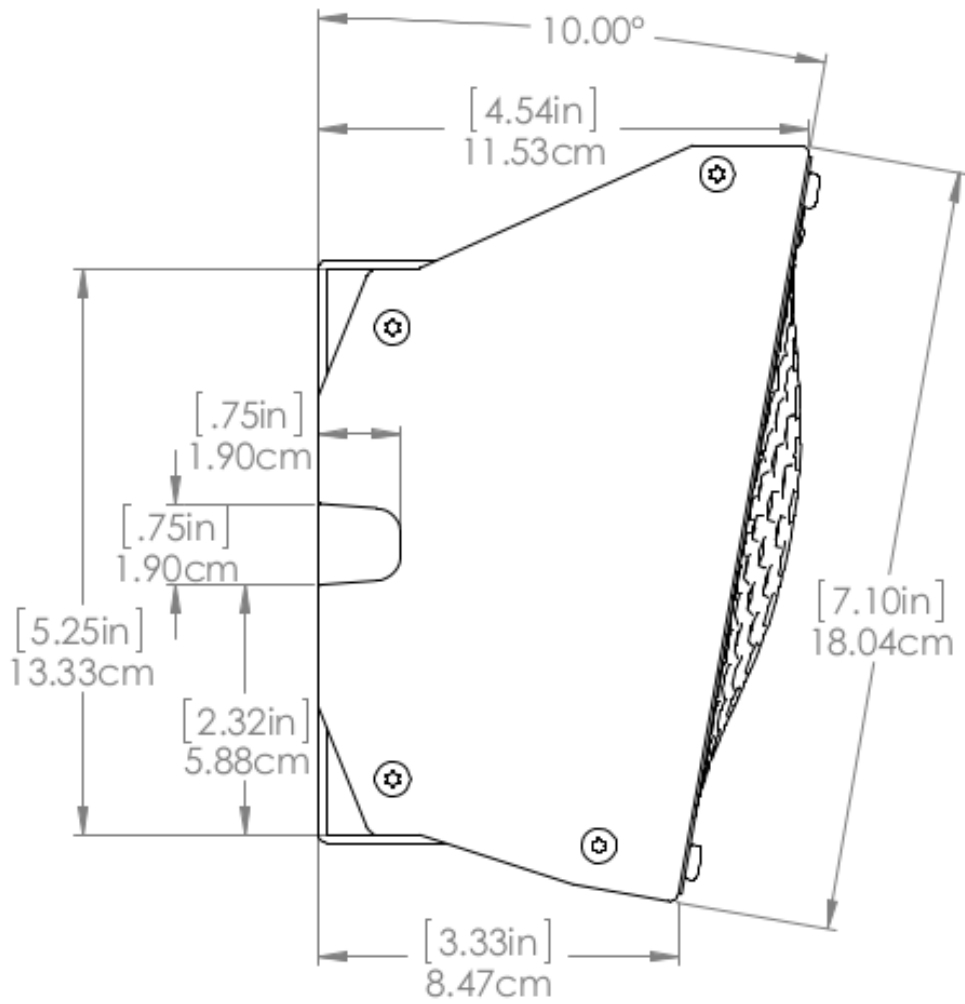

Job Name: Model Numbers: Date:

Location: Notes:

Mounting Bracket

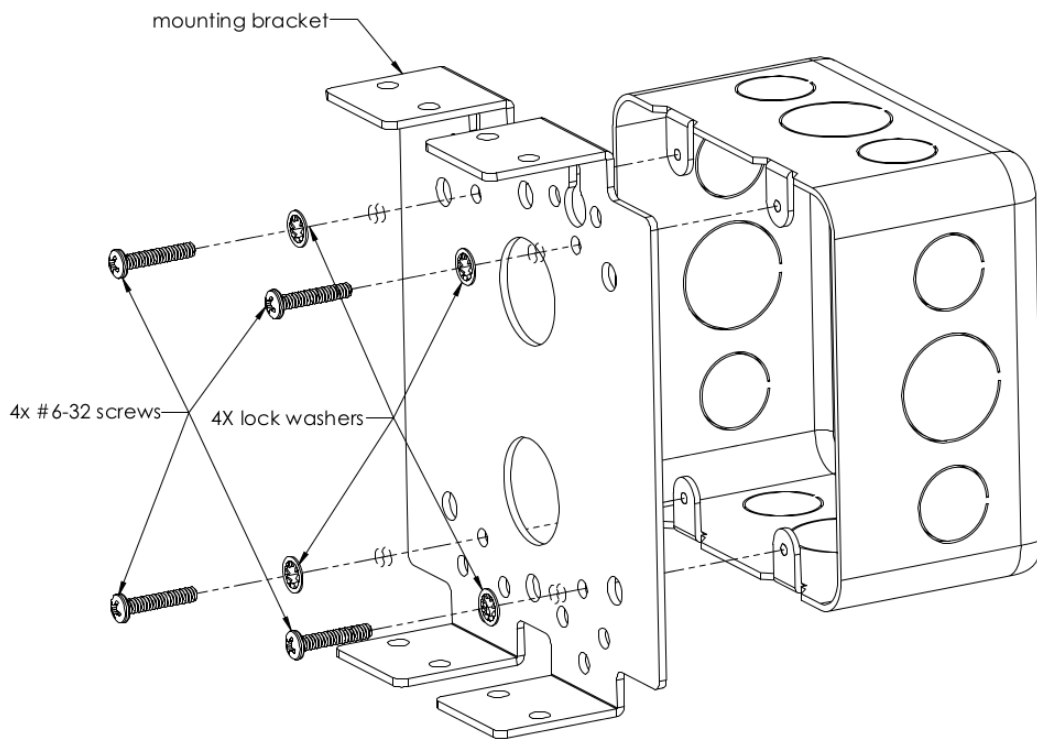

Job Name:

Model Numbers:

Date:

Location:

Notes: