

Carina Small IP Display

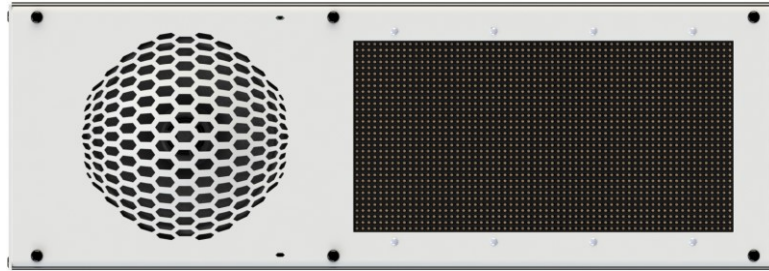

Description

The Carina Small IP Display supports registration with SIP and auto-discovery by the Wahsega Carina Event Manager. With network connectivity, scrolling LED display and built-in speaker, the Carina IP Display broadcasts both audible and visible messages from the Event Manager to classroom occupants. LED text and flasher color, brightness and duration are all configurable for individual Event Manager messages. A built-in microphone allows for two-way SIP communication, and Event Manager's NTP server provides an accurate time and date display when streaming messages are not present. The Carina IP Display can even power a second, analog Wahsega speaker (WL-SPKR-xx-A) up to 20 meters away via PoE cable, increasing audio coverage in the space without requiring an additional cable home run.

Powered via Power over Ethernet (PoE 802.3af), the IP Display is simple to install and is easily programmed within Event Manager's configuration webpages. The IP Display also works with standard panic buttons to trigger an outbound SIP call. With Wahsega's advanced panic button functionality, a brief button press places a call to one preconfigured number—such as the front office—while a longer press-and-hold will call a second, preconfigured panic number. This feature significantly reduces false alarm panic calls. Two onboard relays can be activated by SIP calls or Event Manager broadcasts, triggering door locks or other devices during emergencies.

Wahsega's Carina Event Manager will automatically discover the IP Display, and centralized configuration in Event Manager makes system initialization a breeze. Global and individual programming options within the Event Manager make setup quick and efficient. Both audible and visual feedback at the display let installers know when their system is up and running.

With simple installation and advanced functionality, Wahsega's Carina Small IP Display is perfect for any classroom application, large or small.

Job Name: **Model Numbers:** **Date:**

Location: **Notes:**

Features

- Auto-discovery with Wahsega Carina Event Manager
- Receive alerts and scheduled bells from Wahsega Carina Event Manager
- SIP registration
- PoE 802.3af enabled
- Able to drive Wahsega Extension Speaker up to 20m away via Ethernet
- Centrally configured via simple webpages in Wahsega Event Manager
- Simple surface-mount wall installation
- Built-in microphone for two-way communication
- Web-based mic and speaker volume control
- Classroom sound reinforcement audio input wallplate available
- Status feedback
- Two onboard relays for door control
- RJ45 connections for simplified installation of second speaker and remote sound reinforcement wallplate
- Compatible with standard panic buttons
- Advanced panic button functionality to reduce false alarm triggers
- One to three lines of text display
- Time set by network SNTP Server with no manual adjustments necessary
- Display 12- or 24-hour clock with four or six numerals
- Two color-configurable LED flashers
- One white LED flasher
- Built-in light sensor for energy-reducing auto-dim setting
- Text display is configurable
- 32,768 LED colors
- 32 x 64 resolution
- Text display up to 5" high

Specifications

- Ethernet: 10/100 Mbps
- Power Input: PoE 802.3af
- Standby power: <2 Watts
- Protocol: SIP RFC 3261 compatible
- Audio Codecs: 16-bit PCM (uncompressed), u-law (G.711u), a-law (G.711a), G.722, G.729
- Audio Sampling: 8 kHz, 16 kHz, or 32 kHz
- Speaker Drive Capabilities: 8W (5W per speaker when driving two speakers)
- Speaker Impedance: 8Ω
- Speaker Sensitivity: 96dB 1W/0.5M SPL
- Coverage Angle: 120° / 4 kHz
- Dry Contact Relay Rating: 2A min, 250V AC, 24V DC
- Max PoE Cable Length: 100m (per standard) PoE 10/100 cable length
- Max Secondary Speaker Cat5e or Cat6 Cable Length: 20m
- Temperature Range: -40°C to +60°C
- Weight: 7.2lbs
- Overall Dimensions: 20.39" W x 7.1" H x 4.54" D
- LED Panel Dimensions: 5" tall x 10" wide
- Construction: Metal housing with polyester powdercoat paint
- Warranty: 2 years limited

Job Name: **Model Numbers:** **Date:**

Location: **Notes:**

Model Numbers

WL-IPD-SPKR-510-CAR

Wahsega Labs	Display	Speaker	Display Height	Display Width	Protocol
WL	IPD	SPKR	5	10	CAR
Wahsega Labs	IP Display	with Speaker	5 = 5" High Display	10 = 10" Wide Display 20 = 20" Wide Display 40 = 40" Wide Display D = Double Sided (10" only)	CAR = Carina INF = SIP + InformaCast

Installation

Simple, surface mount wall installation with rear conduit access and side raceway access for wiring. Power supplied via Power over Ethernet (PoE) 802.3af. The Wahsega IP Display can mount to the front a standard 2-gang electrical back box or directly onto the wall, using the appropriate anchors for your surface material. Mounting brackets, screws, washers and lock washers are included.

Job Name: **Model Numbers:** **Date:**

Location: **Notes:**

Dimensions

Front View

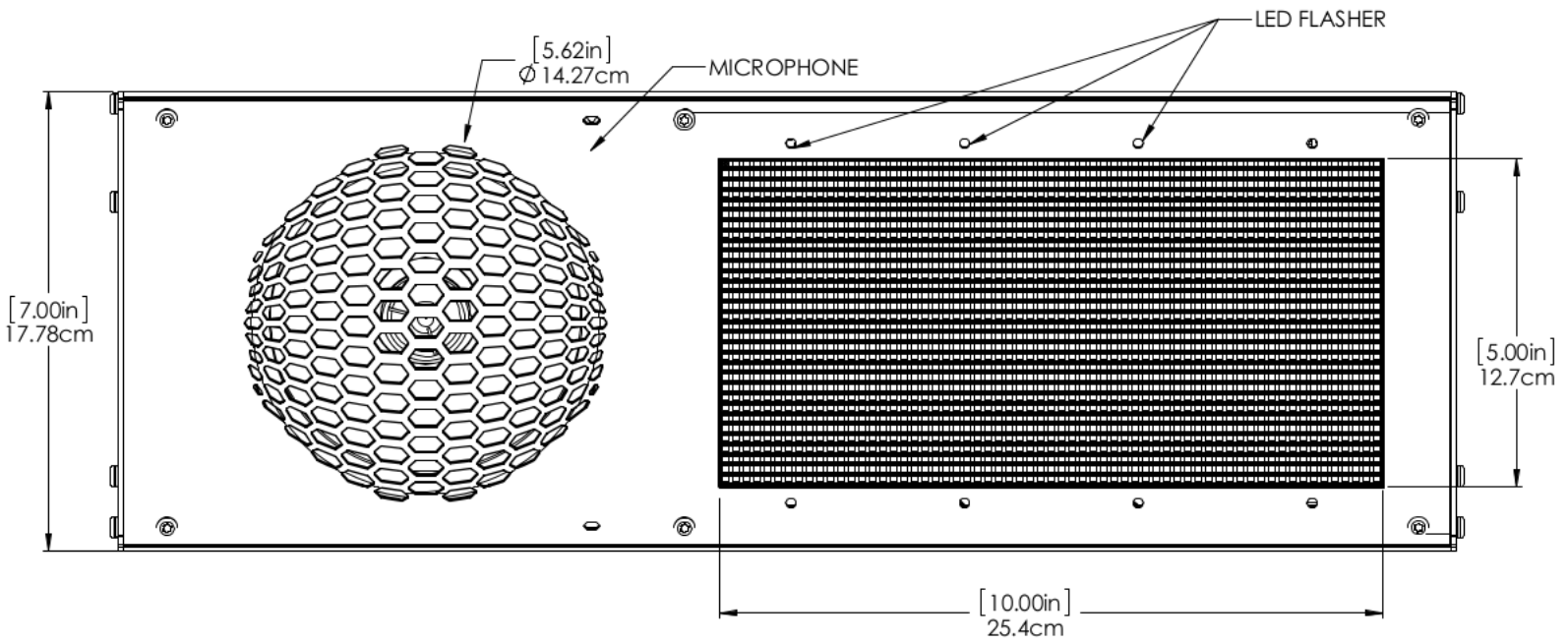

Job Name:

Model Numbers:

Date:

Location:

Notes:

Rear View

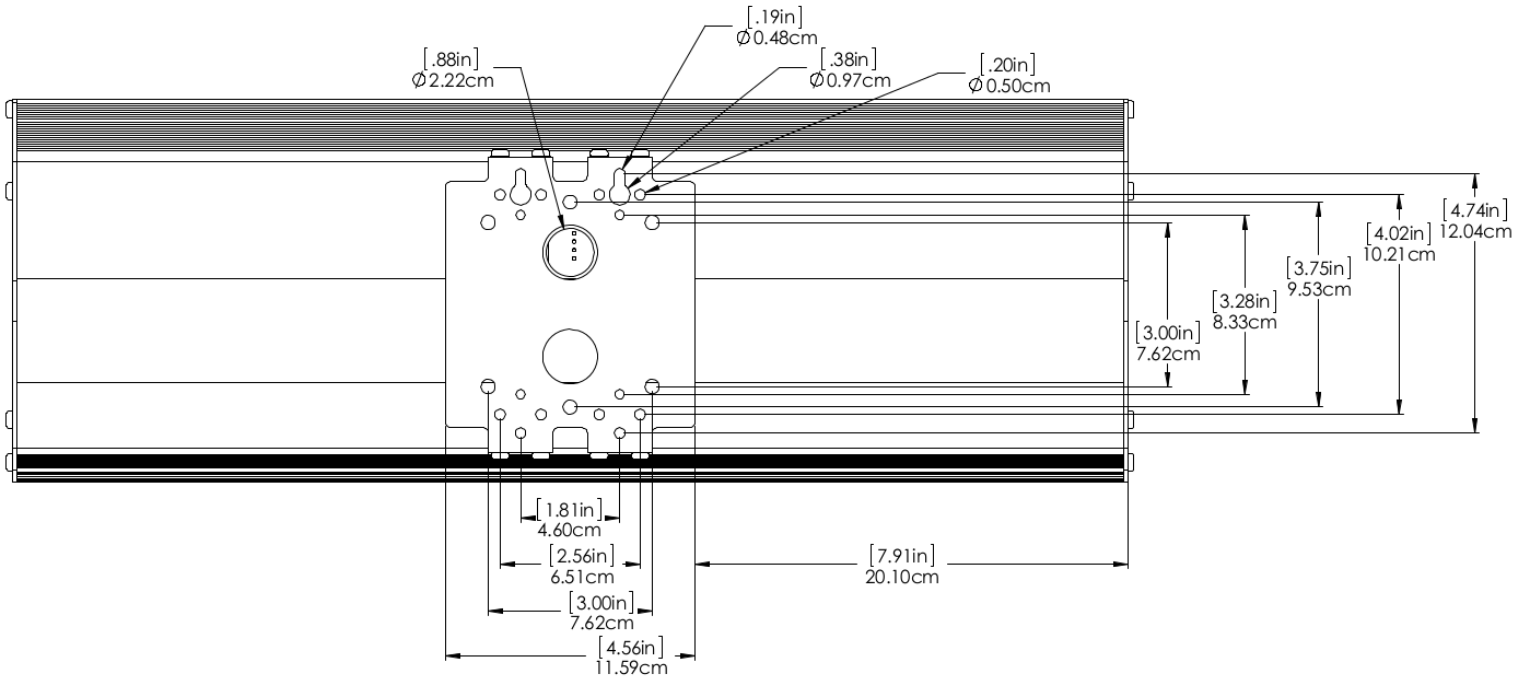

Note: Mounting bracket is included, as shown.
Bracket may be used to mount the IP Display to the front of a standard two-gang electrical backbox.

Job Name: Model Numbers: Date:

Location: Notes:

Side View

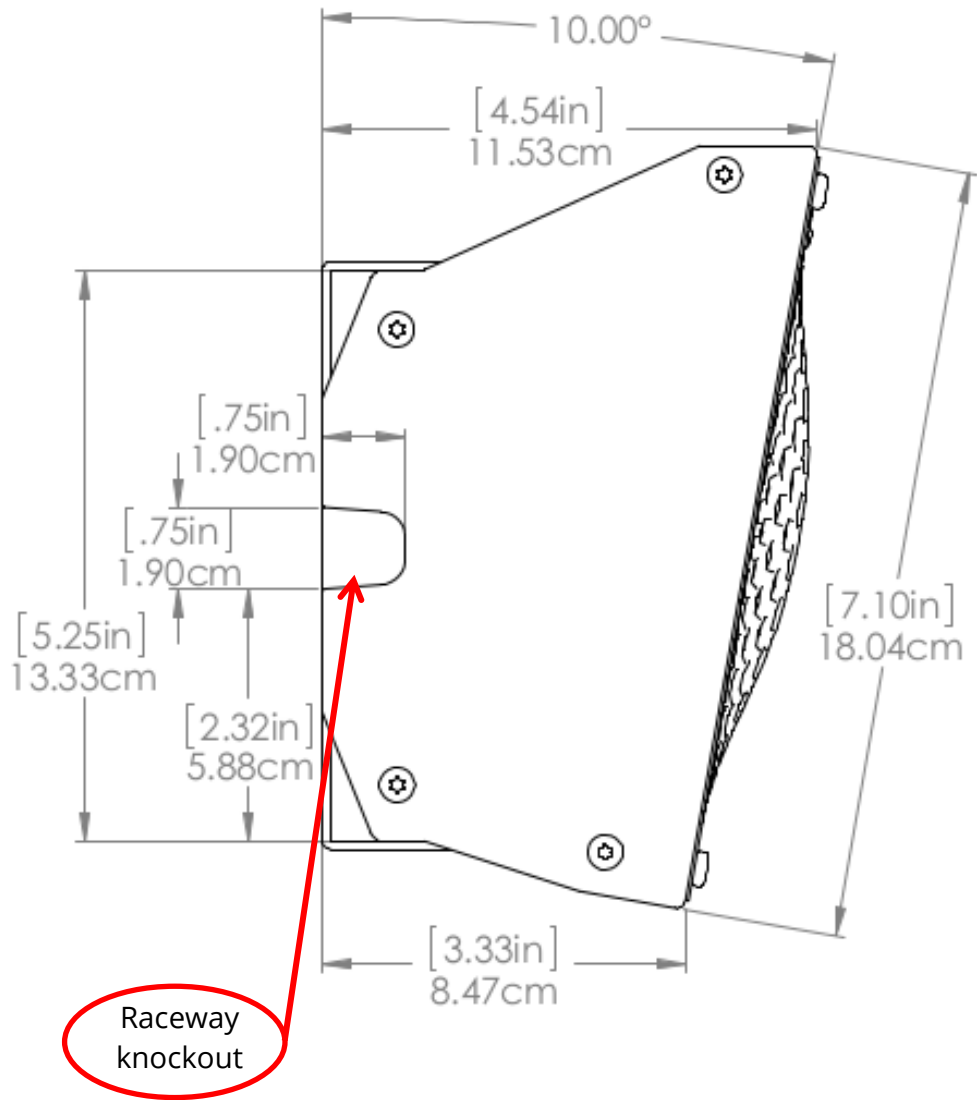

Job Name: Model Numbers: Date:

Location: Notes:

Mounting Bracket

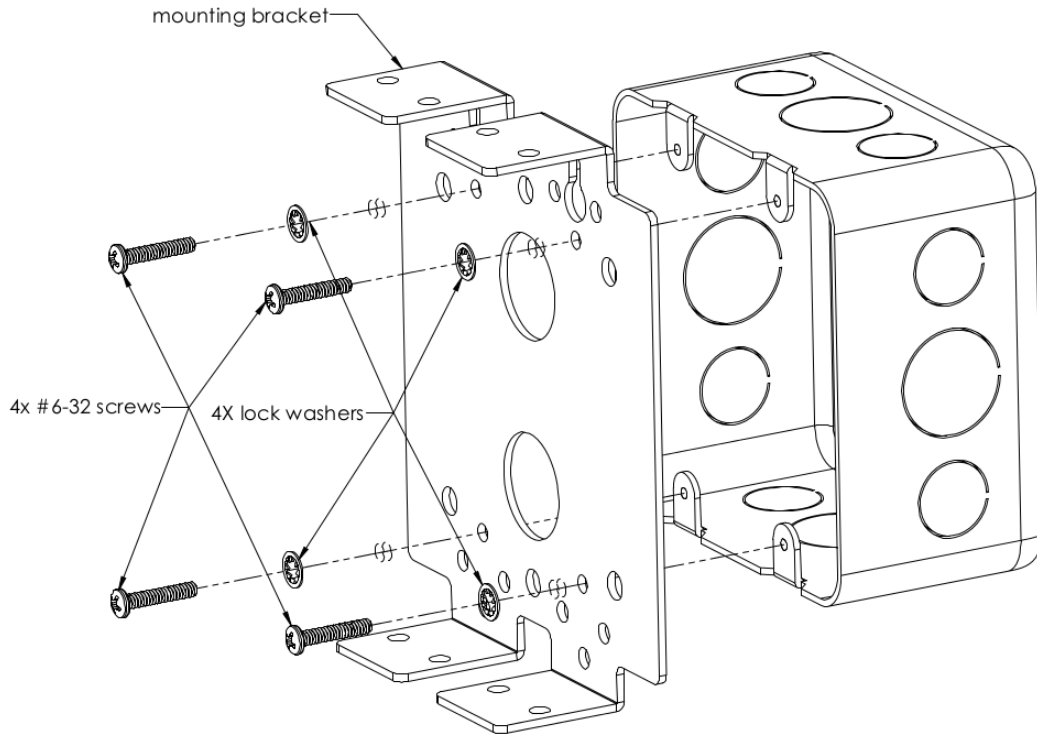

Job Name:

Model Numbers:

Date:

Location:

Notes: